

Replacing the Sensor in an S2 Installation with an S3 Sensor

The new generation Sensor design for the Manager range includes:

1. a terminating resistor
2. an RJ45 plug (the S2 Sensor had an RJ11 plug)
3. a longer R-Bus connection cable

What this means is that rather than branching off the R-Bus network, the S3 Sensor now forms part of the spine. More explanation on this can be found in the Tech Tip “BMS1230S3 R-Bus Spine Explained”.

When replacing a sensor in an existing S2 setup, the new S3 sensor can be used.

After removing the old sensor you simply need to remove the RJ11 clip from the T-Piece and connect the R-Bus cable of the new sensor. You may need to spool the excess length of this cable.

1. Remove the existing S2 Sensor
2. Remove the RJ11 clip from the T-Piece
3. Mount the new S3 Sensor
4. Plug the new Sensor R-Bus cable RJ45 into the T-Piece
5. Spool the excess cable

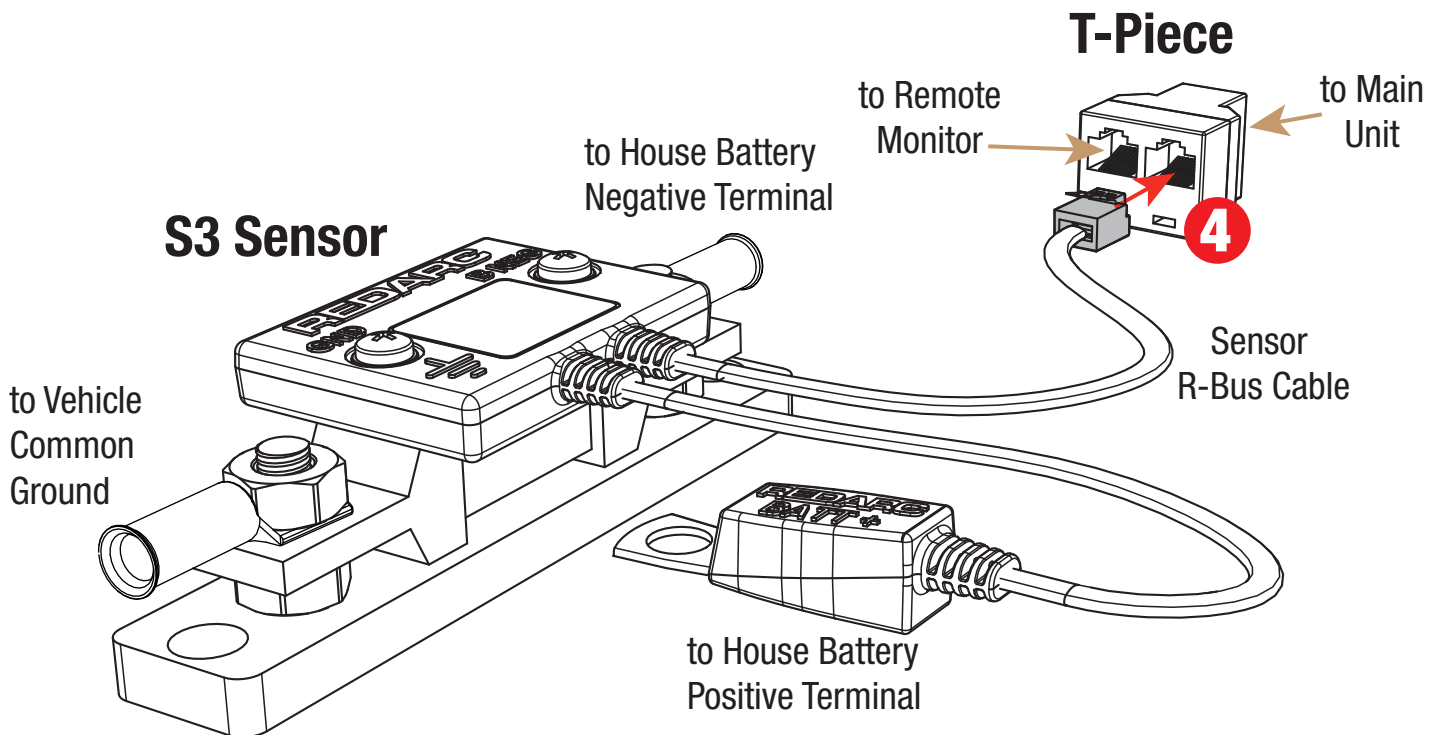
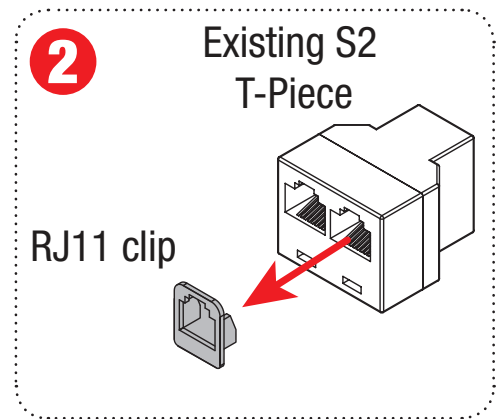

TECH TIP